



GENERAL

The FYREPANEL / PROMAPANEL is a screw fixed fire rated access panel with a laminated MDF or ACP face designed to meet the requirements of the BCA with FRL's of 240/240/120, 120/120/120, 120/120/60 and 60/60/60

USES

The FYREPANEL / PROMAPANEL is approved for installation in walls, shafts and ceilings of fire rated construction where integrity and insulation are required to be maintained to meet that of the building element requiring access through it. Eg: A FRL 120/120/120 wall.

SIZES

The maximum size for masonry and light weight walls is 1500x1000mm and for ceilings is 1200x600mm. Maximum sizes for 4 hour and 2 way applications vary. Please contact Fyreguard for confirmation.

Standard sizes are: 300x300, 400x400, 450x450, 500x500, 600x600 1000x600 & 1200x600mm

Non standard sizes and tile panels are available on request.

FIRE TEST DATA

The Fyreguard FYREPANEL / PROMAPANEL has been tested and assessed to AS1530.4 to provide FRL's up to 240/240/120. Please contact your nearest Fyreguard office for further information.

KEY FEATURES

- Up to 4 hours fire rating
- Wall, Shafts & Ceilings
- Simple Installation
- Australian Made
- Non Standard sizes available

SPECIFICATION

Fyreguard FYREPANEL – Screw Fixed FRL 120/120/120 fire rated access hatch. Wall or Ceiling Application. PH. 07 55934955

INSTALLATION

Refer to this data sheet for installation instructions or contact your nearest Fyreguard office for assistance

MORE DATA

For data on the Fyreguard FYREPANEL Screw Fixed or any other fire rated access panels please do not hesitate to contact us. We reserve the right to change specifications without notice.

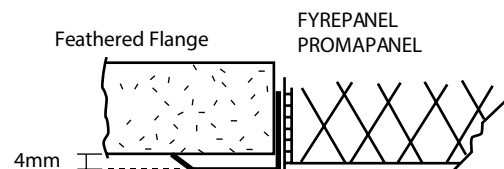



INSTALLATION INSTRUCTIONS

2 HOUR FIRE RATED SCREW FIXED ACCESS PANELS FOR LIGHT WEIGHT AND MASONRY WALLS, AND CEILINGS.

1. Mark out and cut opening in the wall or ceiling.
2. For light weight construction frame the opening with steel studs or trimmers. Ensure studs or trimmers are connected to the ceiling joists, studs or support structure. Line the studs or trimmers with fire rated board of the same thickness as the fire exposed face of the wall or ceiling.
3. Match access panel to the now trimmed and lined opening.
4. Open the hatch/panel and secure frame to the joists or trimmers with steel screws on all 4 sides of the hatch in the holes provided. For masonry applications use steel 50x6mm masonry anchors. NB: Ensure the frame is temporarily packed out before tightening screws or anchors to prevent the frame from distorting. The hatch/panel bolts will not line up with the nuts if distortion occurs. Ensure to remove temporary packers.
5. For 'Set Bead' installations remove the hatch/panel and flush set.
6. While the hatch/panel is open apply fire rated mastic sealant to any gaps between the access panel frame and the inside reveal of the opening.
7. Insert hatch/panel into frame ensuring the correct sides line up – refer to identification points on frame and hatch/panel. Engage all bolts before fully tightening.

TYPICAL FIXING DETAILS:

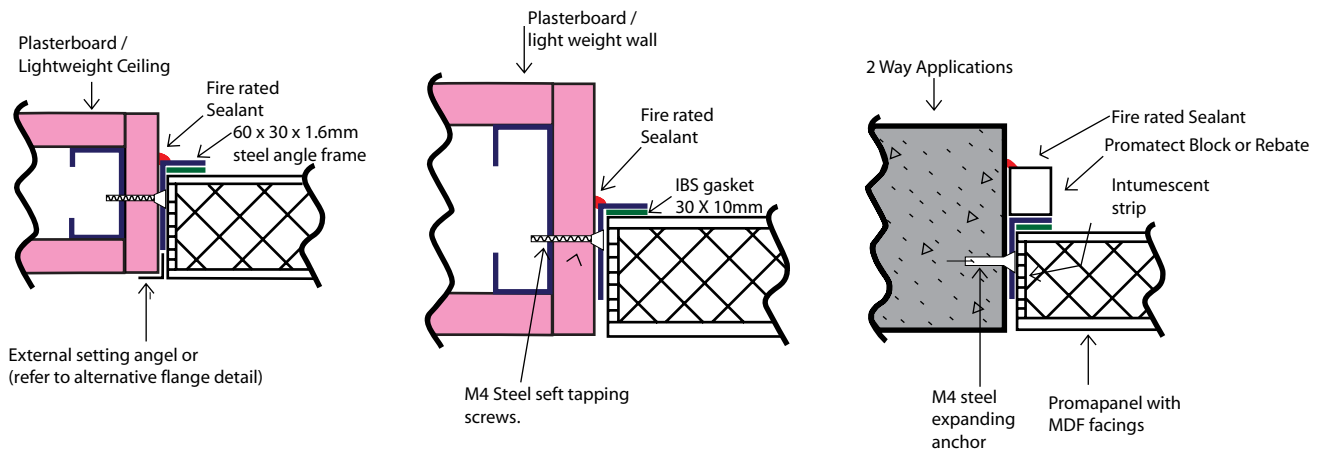

ALTERNATIVE FLANGE DETAILS:

